

Emerald Bay Lot

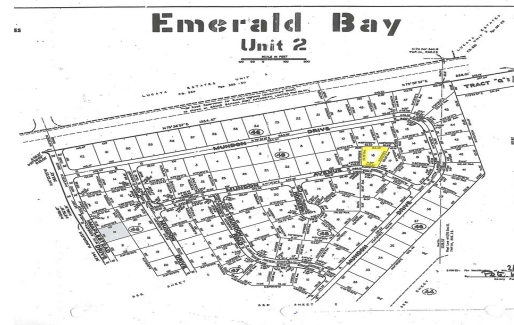
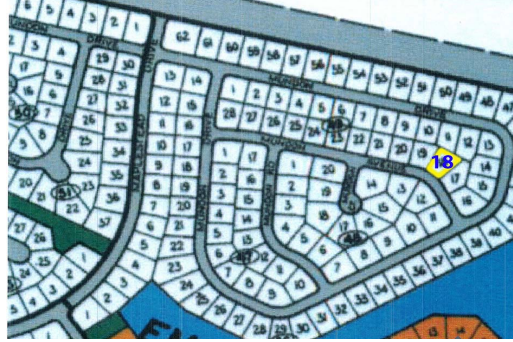
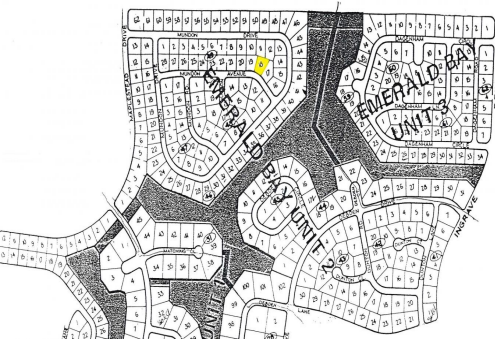

Affordable Single Family Lot For Sale

This Emerald Bay single family lot is situated just over the Casuarina Bridge and is located on Mundon Avenue. Emerald Bay is a very quiet neighborhood, consisting of moderately sized homes perfect for raising a family. This subdivision is just a few minutes away from Port Lucaya Marketplace, the International Airport and the University of the Bahamas....read more on our website.

Lot Size: 13,434 sq ft
Maint. Fees: \$100
Subdivision: Emerald Bay

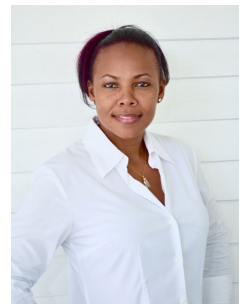

Tiffany Smith

Phone: (242) 351-9081

kekris4@gmail.com



\$20,000 ID# 29324 [View Online](#)
www.sarlesrealty.com

Ph: (242) 351-9081 | Web: www.sarlesrealty.com