

Bootle Bay Lot

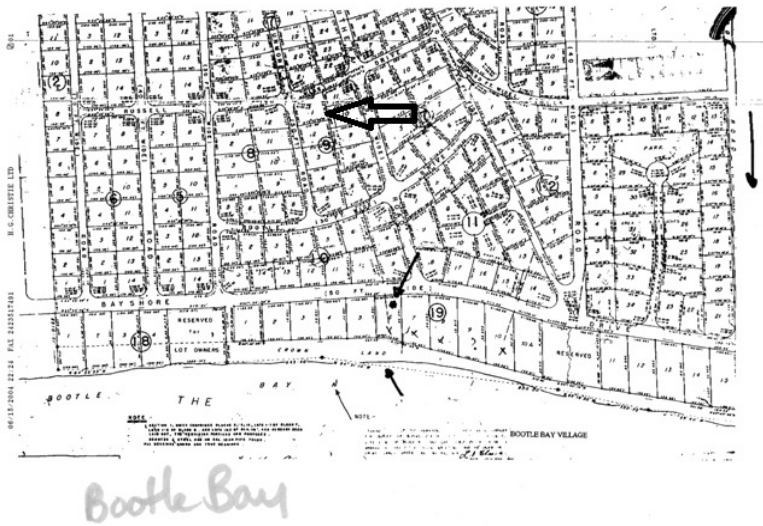

Corner Bootle Bay Lot

This Bootle Bay Lot is located on a corner and is offered at \$ 20,000. This single family zoned lot of land sits a few hundred yards away from pristine white sand beach in growing Bootle Bay Subdivision. There is no annual land service charge. The settlement is very near West End, Grand Bahama's conch capital. ...read more on our website.

Maint. Fees: N/A Tax only
Subdivision: West End /
West Grand Bahama



Ina Simmons

Phone: (242)351-9081
inasimmons@gmail.com



\$20,000 ID# 5478 [View Online](#)
www.sarlesrealty.com