

# Lots/Acreage in Governor's Harbour

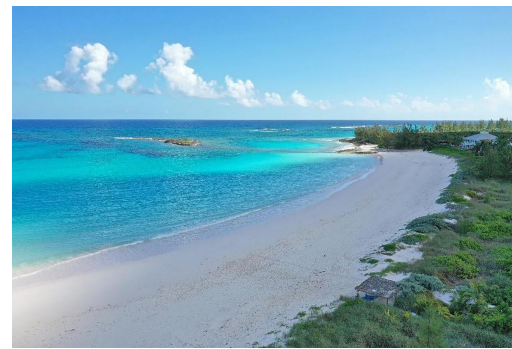
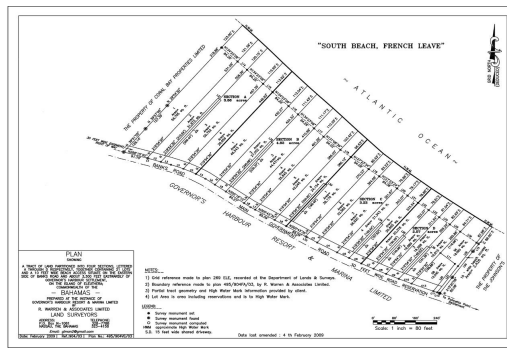
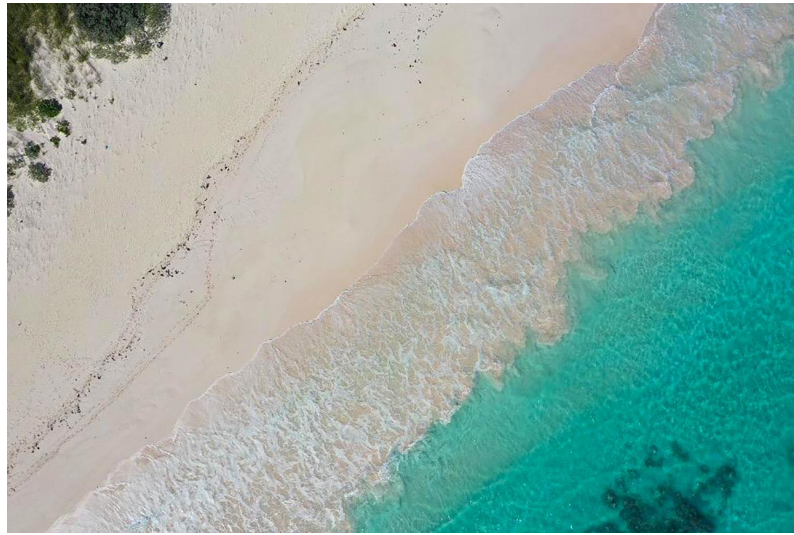

## Lots/Acreage in Eleuthera

French Leave, Eleuthera is certainly the best-kept secret in the Bahamas, with its wide stretch of pink-sand and crystal clear waters. A stone's throw from the picturesque village of Governor's Harbour lies French Leave Beach. This 134<sup>±</sup> x 522.15 feet deep open zoned direct beachfront parcel of land in Section B Lots 3 & 4 consisting of 1.61 acres is prime for a private residence and/or rental vacation home. The lots are serviced with water and electricity. Discover the investment potential of this fabulous beachfront site and experience its peaceful beauty. Stroll the beach, feel the warm sand beneath your feet as year-round summer breezes whisper through the topography of gently rolling hills, canopies of mature coconut trees, and waves caress the shoreline or swim, snorkel, fish, dive,...read more on our website.

Bedrooms: 0  
Bathrooms: 0  
Lot Size: 70132  
Living Area: 0  
Subdivision: Governor's Harbour  
Features: None



James Sarles

Phone: (242) 351-9081  
info@sarlesrealty.com



**\$1.750,000 ID# 48587** [View Online](#)  
[www.sarlesrealty.com](http://www.sarlesrealty.com)